

# VILLAGE OF ELLSWORTH



SOURCES:  
 EXISTING LAND USE, VILLAGE OF ELLSWORTH  
 PARCEL INFORMATION, ANNEKE CO. EQUALIZATION  
 MAP PRODUCTION: EMY AND HEIDINGS & ASSOCIATES

FEBRUARY 2006

## EXISTING LAND USE MAP

- RESIDENTIAL
- COMMERCIAL
- INDUSTRIAL/EXTRACTIVE
- INSTITUTIONAL
- RECREATIONAL
- FORESTED
- NONFORESTED
- WETLANDS
- WATER
- ENVIRONMENTAL RESTORATION



SECTION 36  
NORWOOD TWP. (CHARLEVOIX COUNTY)

GRAND TRAVERSE BAY

TORCH LAKE TWP.

CENTRAL LAKE TWP.

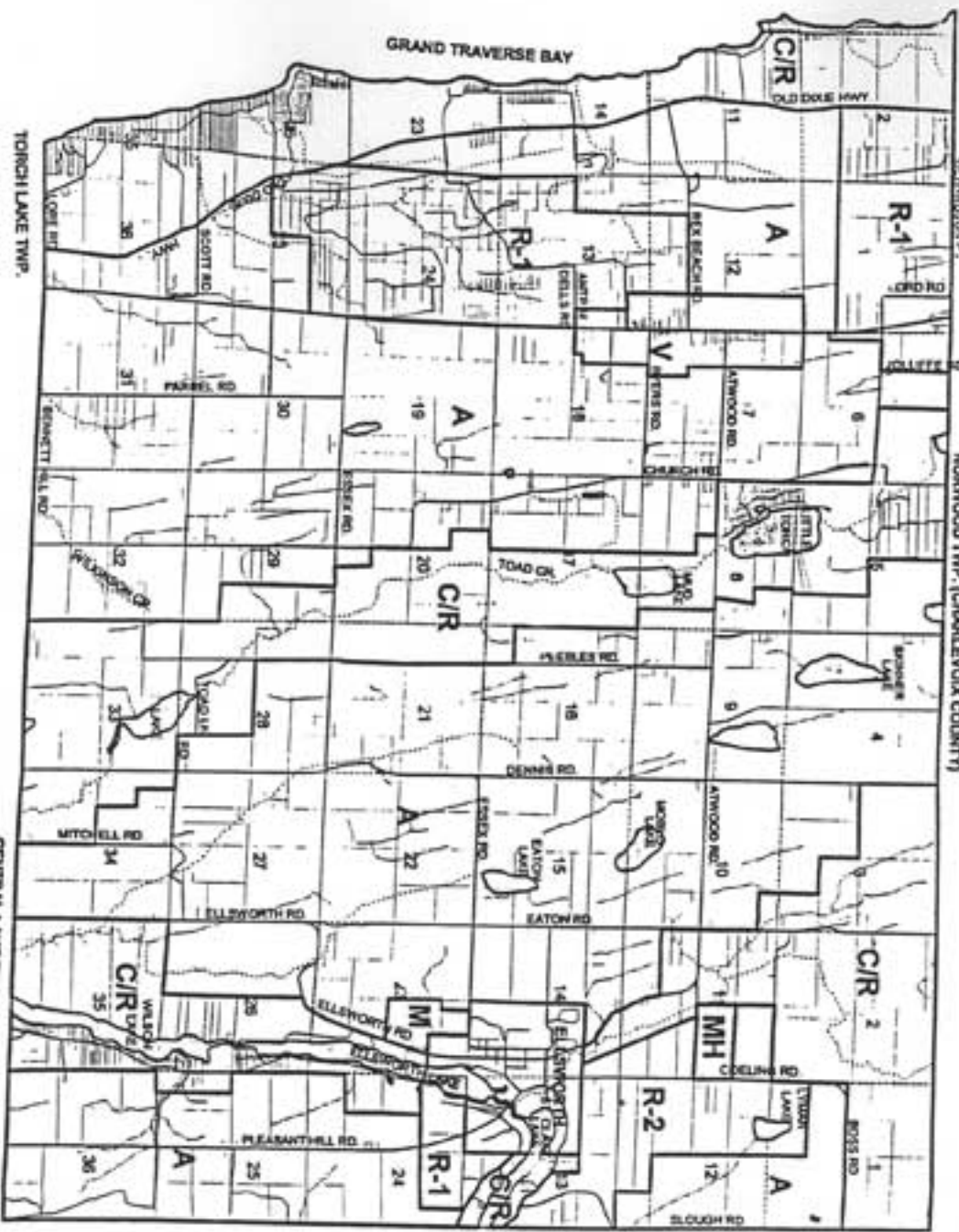

SOUTH ARM TWP. (CHARLEVOIX COUNTY)

**BANKS TOWNSHIP  
ZONING MAP**  
ANTRIM COUNTY, MICHIGAN  
EFFECTIVE DATE: 1-17-02

- PARCELS**  
SECTION LINES  
ROADS AND STREETS  
US-31  
RIVERS AND STREAMS

- Zoning Districts**  
A Agricultural District  
C/R Conservation/ Recreation District  
M Manufacturing District  
MH Mobile Home District  
R-1 Low Density Residential District  
R-2 Medium Density Residential District  
V Village District  
L Lakes



State File Service, LLC  
Operating Since 1951 (Continued)

2000 State of Michigan  
Department of Natural Resources  
1000 West Grand Avenue  
Lansing, MI 48906  
Phone: 313.324.2500  
Fax: 313.324.2501  
www.dnr.state.mi.us

# VILLAGE OF ELLSWORTH

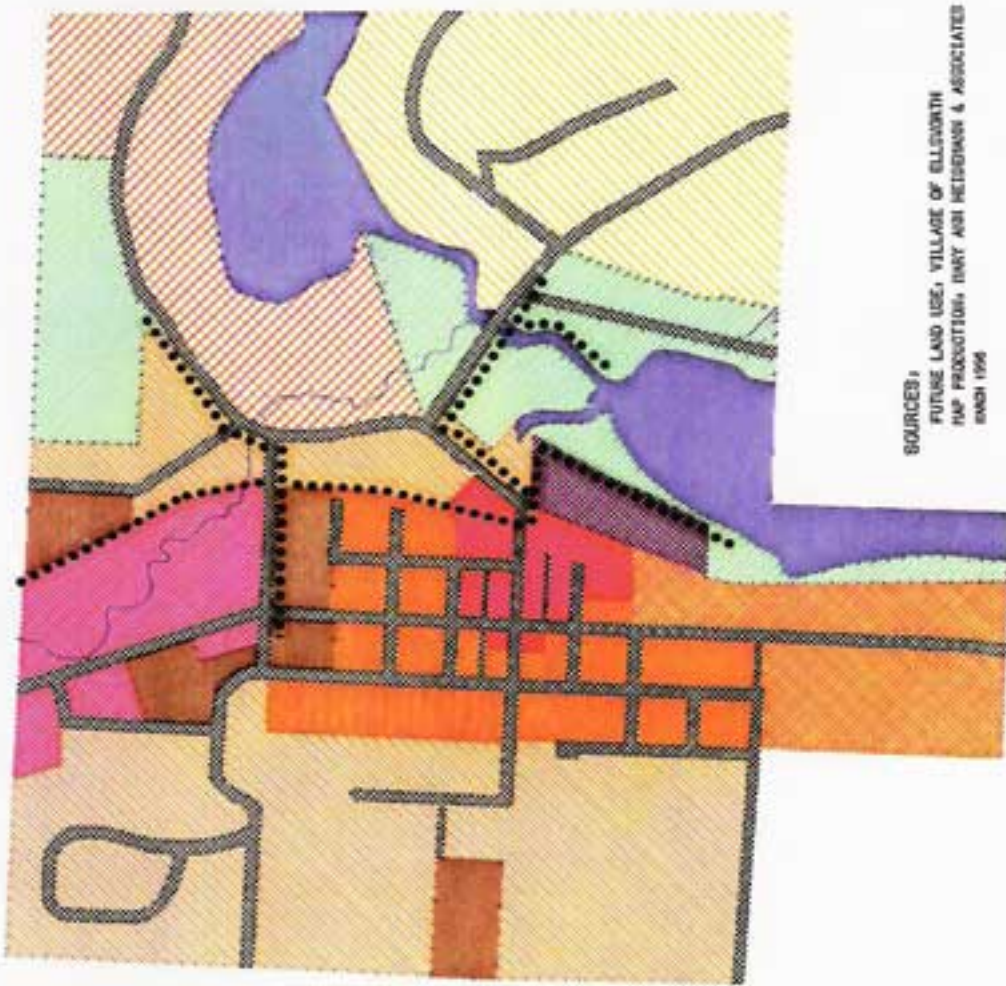

SOURCES:  
 FUTURE LAND USE, VILLAGE OF ELLSWORTH  
 MAP PRODUCTION, DARYL ASH HEIDEMAN & ASSOCIATES  
 MARCH 1996

## FUTURE LAND USE MAP

RECREATION/CONSERVATION

RESIDENTIAL

VILLAGE

MULTIPLE-FAMILY

GENERAL

ESTATE

COMMERCIAL

VILLAGE

GENERAL

TOURISM

PUBLIC SERVICE

SPECIAL DEVELOPMENT AREA

FUTURE TRAIL



(A)

# NORTHWEST MICHIGAN Ten County Region

▲ Indicates State Parks

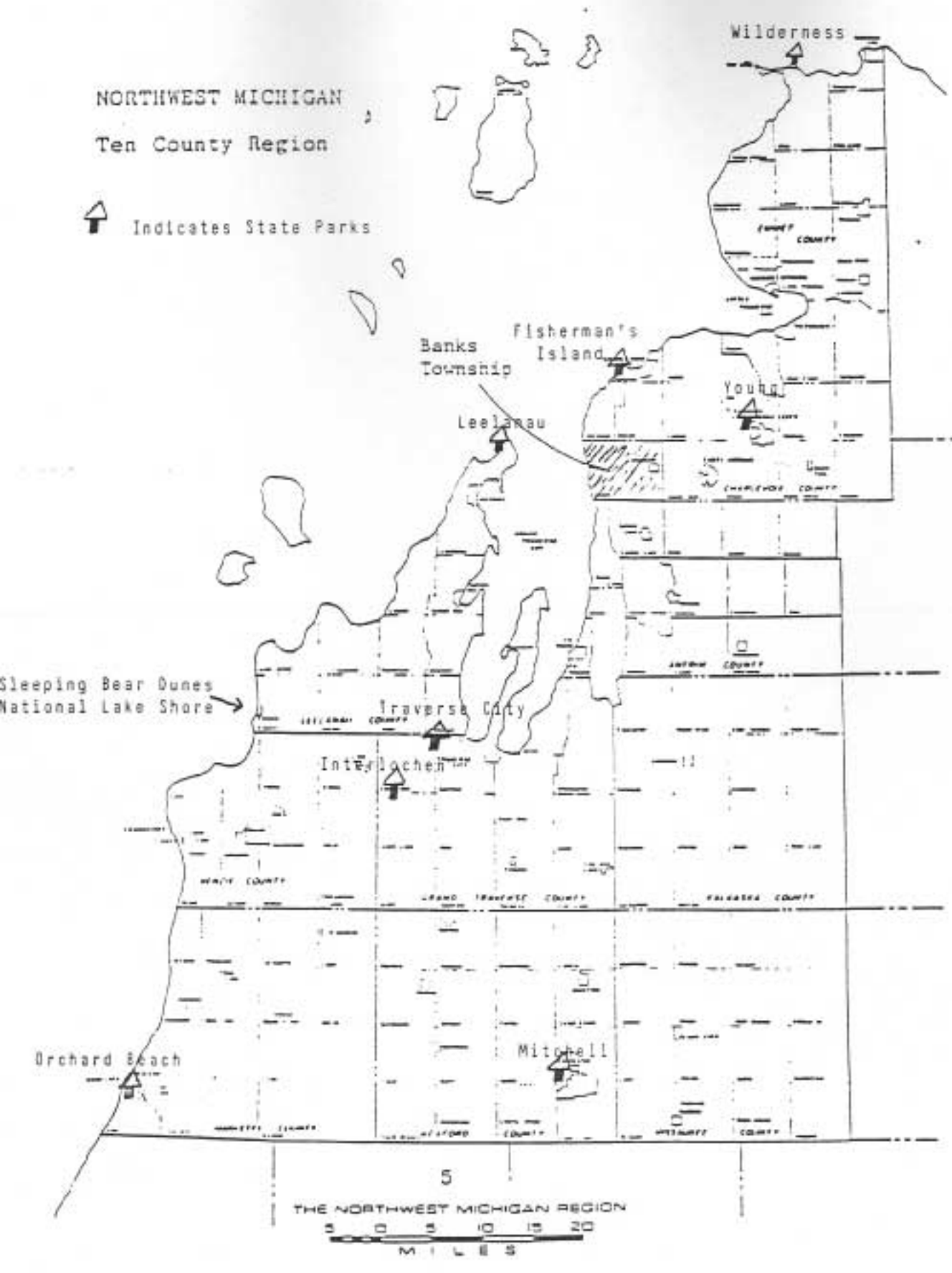

Sleeping Bear Dunes National Lake Shore →

Orchard Beach ▲



VILLAGE OF  
ELLSWORTH

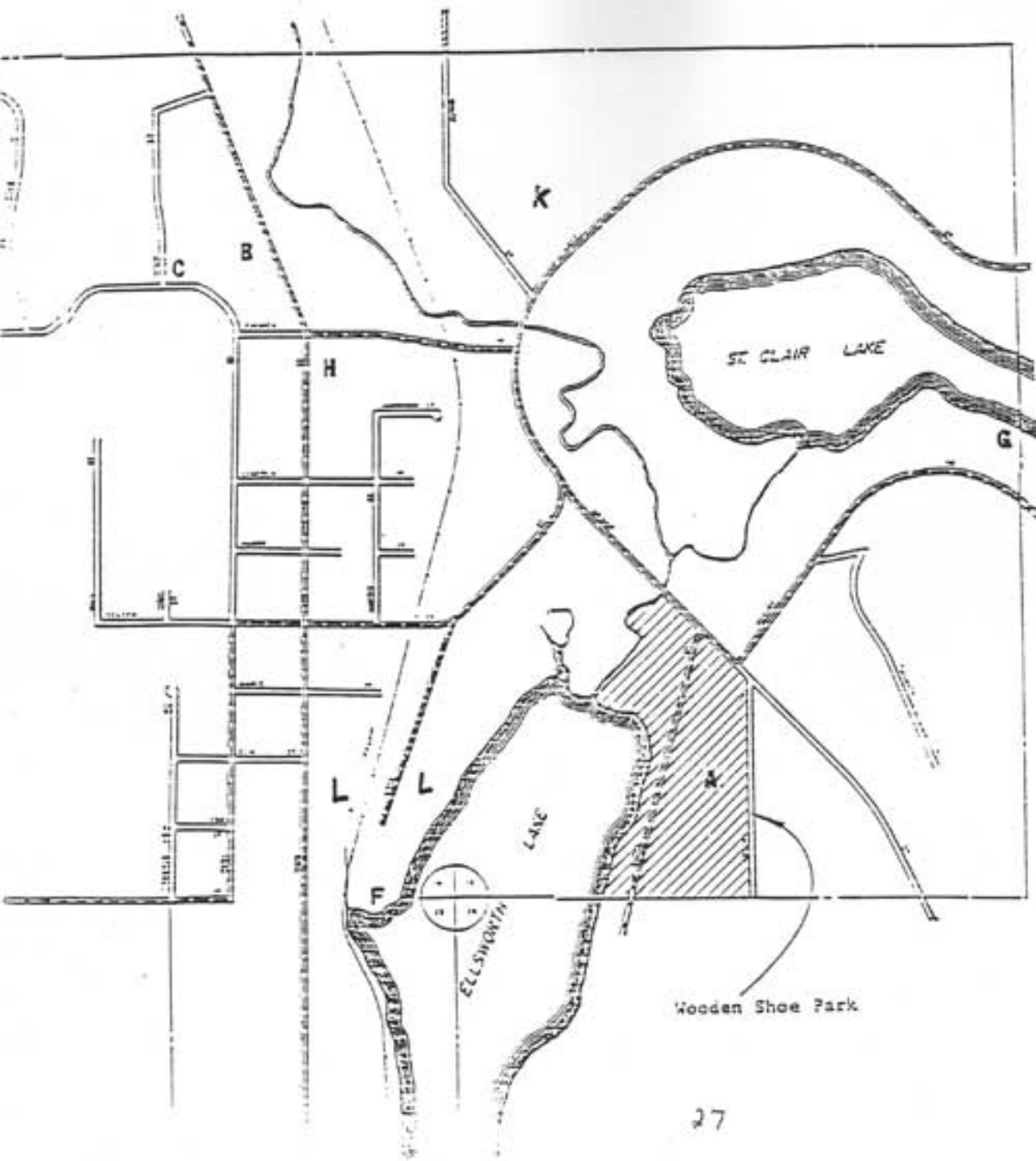



# SCHOOL DISTRICT MAP



- 
Central Lake  
Public Schools
- 
Charlevoix Public  
Schools
- 
Elsworth Public  
Schools

**Barrier Free Status of Parks**

Park Name	Parking	Restroom	Pavilion	Drinking Fountain	Picnic Area	Play Equipment	Trails	Sidewalk	Bench	Water Access
Ellsworth Community Park	P	P	P	P	NA	P	NA			
Wooden Shoe Park (Upper Area)		P		P						
Lower Park				NA						
Village Athletic Complex			NA			NA	P			
Village Tennis Courts				P						
Lions Club Basketball Court				P						
Banks Township Park	H	H								
Antrim Creek Natural Area										

H = Handicap Accessible P= Proposed  
NA = Not Applicable / Feature or Facility not present

**Ellsworth Community Park** – This park is currently undeveloped. This park is located in the heart of Ellsworth and is a high priority in terms of re-development. The site was turned over to the Village following an extensive MDEQ clean up of contamination from former industrial activities. Plans are being prepared to develop this park as with a handicap accessible pavilion, restrooms, picnic areas, parking area landscaping and a labyrinth. This site will serve as one end of a proposed multi-purpose pathway and provide accessible restrooms and parking for pathway users.

**Wooden Shoe Park (Upper Portion)**—This park primarily consists of a 60 site campground on two levels. While none of the sites are officially designated as handicap accessible sites, the campground has been managed in a way to offer the sites on the upper level to anyone with physical movement limitations. The Village proposes to add a separate accessible unisex restroom/ shower facility, as well as providing some accessible picnic tables at some of the sites.

MAP LOCATING PROPOSED AREAS AND FACILITIES TO BE ACCOMPLISHED  
OVER THE NEXT FIVE (5) YEARS

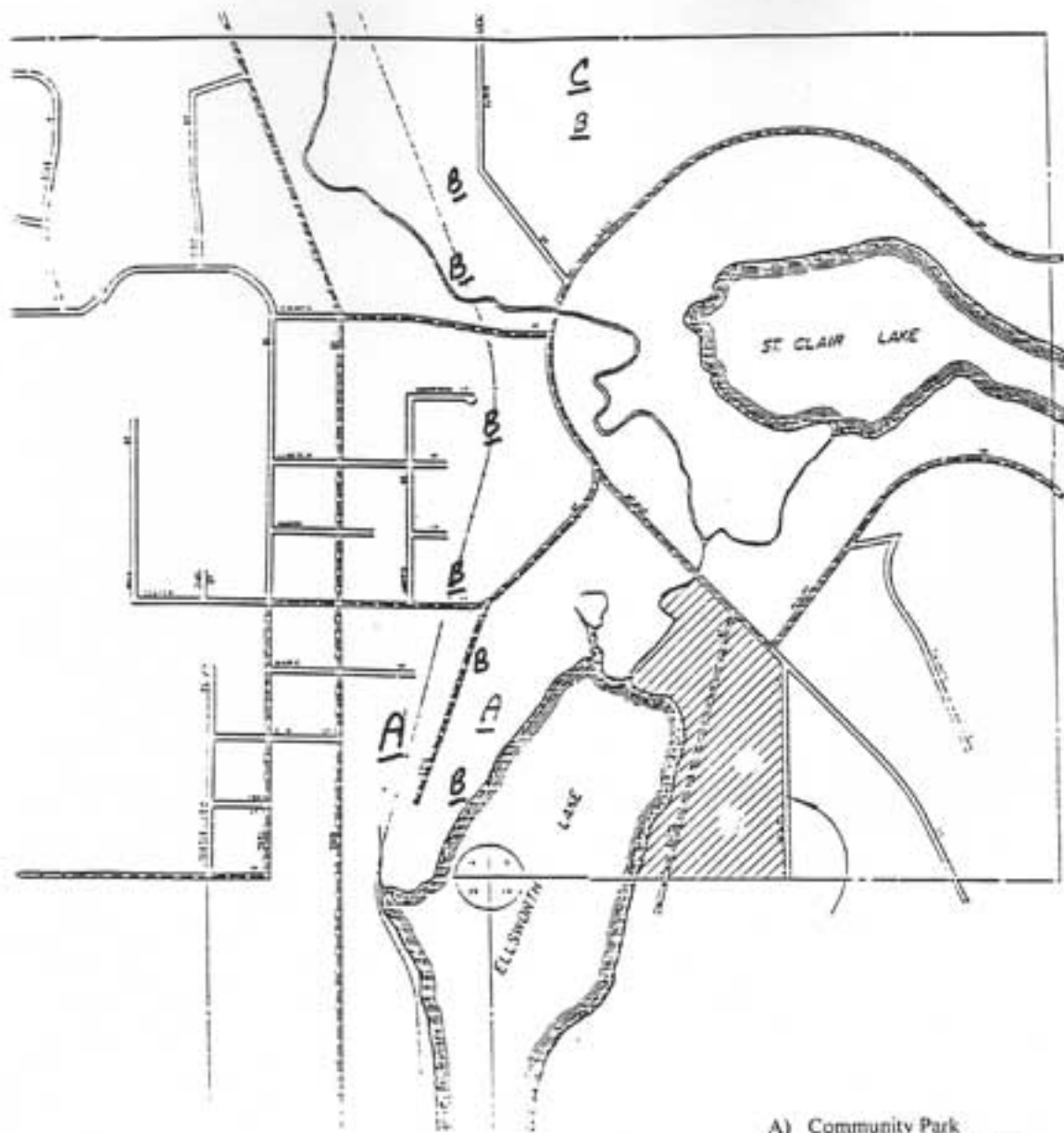

- A) Community Park
- B) Non Motorized Pathway
- C) Land Acquisition

MAP LOCATING PROPOSED AREAS AND FACILITIES TO BE ACCOMPLISHED  
OVER THE NEXT FIVE (5) YEARS



D) Banks Township Park